

**SCOTT + REID**  
General Contractors

*REVIEW*  
*Supporting*  
*Time Line*  
*\* Documentation*  
*Email*

UPDATED  
6-Apr-24

Standard Invoice Form

To: Scott + Reid General Contractors  
15207 Addison Rd  
Addison, TX 75001  
469.374.3400  
ap@scottandreid.com (Dallas)  
apayable@scottandreid.com (Houston)

From: Heartland Sports Turf  
101 Stewart Rd  
Stigler, OK 74462

Project Name	S+R JobNumber	Sub InvoiceNumber	BillThrough	DrawNumber
Otoe Missouri - RV Park PH 2	3.608-1-03	Pay #	15-Apr-24	

Original Contract Amount:	\$106,095.00
Approved Change Orders (CO) to Date:	\$71,521.86
Revised Contract Amount:	\$177,616.86
Total Work Completed to Date:	100%
Less Gross Amount Previously Invoiced:	\$21,850.00
Gross Amount Due This Pay Period:	\$155,766.86
Less 10% Retainage:	\$15,576.69
Net Due This Payment:	\$140,190.17

S&R CH#17705 Turf Hub TH-#17705 (\$1.29) 10 Rolls

SubcontractorCo Number	HSUBcontractCO Number*	Description of Change	Amount
Change Order #1	HST	Contract Labor - See Quote Attached	\$0.00
Change Order #2R1	HST	Labor ADD for Installation ONLY of Grills & Tables	\$0.00

Turf Hub	#77433 (10-05-2023)	WHAT WAS THIS FOR - PH 1 EXTRA ROLL	\$8,700.00
Turf Hub	#64935 - (4-1-2024)	15 Rolls Turf (86118) Bermuda Blend (\$1.19) + Shipping	\$29,775.00
Turf Hub	#85125 - (4-4-2024)	5 Rolls Turf (86118) Bermuda Blend (\$1.19) + Shipping	\$10,825.00
			\$49,300.00
			\$140,190.17
			\$90,890.17

*OWE*  
*TH*  
*BY TOL*

*OWP*  
*TO HST*

\*\* If a subcontract change order has not been issued by S+R, please not the S+R employee/date this change was "approved."

Incomplete applications will be rejected. Once rejected, you will no be eligible to submit a pay application until the following month.

SUBCONTRACT AGREEMENT  
SCOTT + REID GENERAL CONTRACTORS, INC.



Invoice

101 Stewart Road | Stigler, OK 74462 | 405.915.5155

Date: April 6, 2024  
Project: Newkirk 7 Clans Casino - PH 2 RV Park WELCOME CENTER ONLY

3/13/24

BILL TO : Scott + Reid General Contractors      SHIP TO: Newkirk Casino

We are pleased to quote the following items:      Attn: Mr. Brian Travis

TERMS: Net 30      \*Pricing valid for 45 days

ITEM NO.	QTY	DESCRIPTION	UNIT	UNIT PRICE	TOTAL
	11	PH 2 RV Park Islands - 1200sf Each Includes All Required Turf, Aggregate & Materials Sub Base to be 6" from Grade		\$ 8,895.00	\$ 97,845.00
	11	RV Island Table Assembly & Installation Anchord to Concrete		\$ 375.00	\$ 4,125.00
	11	RV Island Grill Assembly & Installation Set into Concrete		\$ 375.00	\$ 4,125.00
	1	*Additional 4,500sf of synthetic turf around existing building		\$ 33,390.00	\$ 33,390.00
	1	*Additional 5,146sf of synthetic turf around existing building		\$ 38,131.86	\$ 38,131.86
		<i>*Includes all required turf, aggregate &amp; materials Sub base to be 6" from final grade. Pricing Includes Materials, Freight &amp; Labor to Install Tables and Grills Provided by Owner</i>			
		NOTES: SALES TAX IS NOT INCLUDED			
		Thank You !			

Authorized by \_\_\_\_\_

Please return with order

Subtotal	
Total	\$ 177,616.86

Jason McMahan



www.heartlandsturf.com  
D: (405) 915-5155



Invoice

101 Stewart Road | Stigler, OK 74462 | 405.915.5155

Date: April 6, 2024  
Project: Newkirk 7 Clans Casino - PH 2 RV Park WELCOME CENTER ONLY

3/13/24

BILL TO : Scott + Reid General Contractors      SHIP TO: Newkirk Casino

Revised from original contract submitted

We are pleased to quote the following items:      Attn: Mr. Brian Travis

TERMS: Net 30      \*Pricing valid for 45 days

ITEM NO.	QTY	DESCRIPTION	UNIT	UNIT PRICE	TOTAL
	11	PH 2 RV Park Islands - 1200sf Each Includes All Required Turf, Aggregate & Materials Sub Base to be 6" from Grade		\$ 8,895.00	\$ 97,845.00
	11	RV Island Table Assembly & Installation Anchord to Concrete		\$ 375.00	\$ 4,125.00
	11	RV Island Grill Assembly & Installation Set into Concrete		\$ 375.00	\$ 4,125.00
	1	Additional 4,500sf of synthetic turf around existing building Includes all required turf, aggregate & materials Sub base to be 6" from final grade.  Pricing Includes Materials, Freight & Labor to Install Tables and Grills Provided by Owner NOTES: SALES TAX IS NOT INCLUDED  Thank You !		\$ 33,390.00	\$ 33,390.00
Subtotal					
Total					\$ 139,485.00

Authorized by \_\_\_\_\_  
Please return with order

Jason McMahan



www.heartlandssportsturf.com  
D: (405) 915-5155





101 Stewart Road | Stigler, OK 74462 | 405.915.5155

3/13/24

Project: **Newkirk 7 Clans Casino - PH 2 RV Park WELCOME CENTER ONLY**

**SHIP TO:** Newkirk Casino

Change Order Additional 5,146sf Material / Labor

**Attn: Mr. Brian Travis**

**\*Pricing valid for 45 days**

ITEM NO.	QTY	DESCRIPTION	UNIT	UNIT PRICE	TOTAL
	1	Additional 5,146sf of synthetic turf around existing building Includes all required turf, aggregate & materials Sub base to be 6" from final grade. Pricing Includes Materials, Freight & Labor to Install		\$ 38,131.86	\$ 38,131.86
		NOTES: SALES TAX IS NOT INCLUDED  Thank You !			
<b>Subtotal</b>					
<b>Total</b>					\$ 38,131.86

Authorized by \_\_\_\_\_

Please return with order



D: (405) 915-5155





TurfHub  
SYNTHETIC GRASS SUPPLIER

1725 E. GERMANN RD. SUITE 19 | CHANDLER, AZ 85286  
1.800.383.8229 | TURFHUB.COM

Invoice

Date	Invoice #
4/1/2024	84935

Bill To	Ship To
Heartland Sports Turf Jason McMahan 101 Stewart Rd Stigler, OK 74462	Jason Si'i 4/1 12875 N Hwy 77 Newkirk OK 74647

Rep	P.O. Number	Terms	Ship Date	Project
DA	7 Clans Phase 2	Net 30	3/25/2024	

Quantity	Item	Description	MO #	Roll #	Price Each	Amount
1,500	DV-330	Bermuda Blend Roll Size:		394	1.19	1,785.00T
1,500	DV-331	Bermuda Blend Roll Size:		395	1.19	1,785.00T
1,500	DV-332	Bermuda Blend Roll Size:		396	1.19	1,785.00T
1,500	DV-333	Bermuda Blend Roll Size:		397	1.19	1,785.00T
1,500	DV-334	Bermuda Blend Roll Size:		398	1.19	1,785.00T
1	Shipping	Shipping- Jason Si'i 4/1 BOL Q#			3,000.00	26,775.00 3,000.00
		Address- 12875 N Hwy 77 Newkirk OK 74647				
		Sales Tax			0.00%	0.00

Customer Disclosure

No refunds or exchanges unless authorized by TurfHub. Purchasing customer will be responsible for window treatments on any windows that may cause melting of turf material. Damage caused by reflection (melting) or other flammable materials is not covered under turf warranty. Additionally melting caused by other hot surfaces and roll crush is not covered under warranty. Zeolite infill breaking down and discoloring turf is not covered under warranty. Any stains or discoloration caused by excessive watering is also not covered under warranty. Damage caused to turf material by invasive vegetation including but not limited to, nut grass nut sage, roots and similar growths will not be covered under warranty. All synthetic turf is subject to normal wear and tear. Normal wear and tear is not a manufacturer defect and is not covered under warranty.

Any invoice that becomes more than 30 days past due, can and will be subject to auto debiting from your checking account or credit card without notice and a 15% restocking fee will be charged for all returns

By signing or receiving this invoice by email you are agreeing to the terms and conditions listed on this invoice.

Signature \_\_\_\_\_ Date \_\_\_\_\_

Subtotal	\$29,775.00
Total	\$29,775.00
Payments/Credits	\$0.00
Balance Due	\$29,775.00



TurfHub  
SYNTHETIC GRASS SUPPLIER

1725 E. GERMANN RD. SUITE 19 | CHANDLER, AZ 85286  
1.800.383.8229 | TURFHUB.COM

Invoice

Date	Invoice #
4/1/2024	84935

Bill To	Ship To
Heartland Sports Turf Jason McMahan 101 Stewart Rd Stigler, OK 74462	Jason Si'i 4/1 12875 N Hwy 77 Newkirk OK 74647

		Rep	P.O. Number	Terms	Ship Date	Project	
		DA	7 Clans Phase 2	Net 30	3/25/2024		
Quantity	Item	Description		MO #	Roll #	Price Each	Amount
1,500	DV-320	Bermuda Blend			106	1.19	1,785.00T
		Roll Size:					
1,500	DV-321	Bermuda Blend			107	1.19	1,785.00T
		Roll Size:					
1,500	DV-322	Bermuda Blend			108	1.19	1,785.00T
		Roll Size:					
1,500	DV-323	Bermuda Blend			109	1.19	1,785.00T
		Roll Size:					
1,500	DV-324	Bermuda Blend			110	1.19	1,785.00T
		Roll Size:					
1,500	DV-325	Bermuda Blend			111	1.19	1,785.00T
		Roll Size:					
1,500	DV-326	Bermuda Blend			390	1.19	1,785.00T
		Roll Size:					
1,500	DV-327	Bermuda Blend			391	1.19	1,785.00T
		Roll Size:					
1,500	DV-328	Bermuda Blend			392	1.19	1,785.00T
		Roll Size:					
1,500	DV-329	Bermuda Blend			393	1.19	1,785.00T
		Roll Size:					

Customer Disclosure

No refunds or exchanges unless authorized by TurfHub. Purchasing customer will be responsible for window treatments on any windows that may cause melting of turf material. Damage caused by reflection (melting) or other flammable materials is not covered under turf warranty. Additionally melting caused by other hot surfaces and roll crush is not covered under warranty. Zeolite infill breaking down and discoloring turf is not covered under warranty. Any stains or discoloration caused by excessive watering is also not covered under warranty. Damage caused to turf material by invasive vegetation including but not limited to, nut grass nut sage, roots and similar growths will not be covered under warranty. All synthetic turf is subject to normal wear and tear. Normal wear and tear is not a manufacturer defect and is not covered under warranty.

Any invoice that becomes more than 30 days past due, can and will be subject to auto debiting from your checking account or credit card without notice and a 15% restocking fee will be charged for all returns

By signing or receiving this invoice by email you are agreeing to the terms and conditions listed on this invoice.

Signature \_\_\_\_\_ Date \_\_\_\_\_

Subtotal
Total
Payments/Credits
Balance Due





TurfHub  
SYNTHETIC GRASS SUPPLIER

1725 E. GERMANN RD. SUITE 19 | CHANDLER, AZ 85286  
1.800.383.8229 | TURFHUB.COM

Invoice

Date	Invoice #
4/4/2024	85125

Bill To	Ship To
Heartland Sports Turf Jason McMahan 101 Stewart Rd Stigler, OK 74462	Jason Si'i 12875 N Hwy 77 Newkirk OK 74647

		Rep	P.O. Number	Terms	Ship Date	Project	
		DA	7 Clans Phase 2...	Net 30	4/3/2024		
Quantity	Item	Description		MO #	Roll #	Price Each	Amount
1,500	DV-335	Bermuda Blend Roll Size:		86118	*399	1.19	1,785.00T
1,500	DV-337	Bermuda Blend Roll Size:		86118	*401	1.19	1,785.00T
1,500	DV-339	Bermuda Blend Roll Size:		86118	*403	1.19	1,785.00T
1,500	DV-340	Bermuda Blend Roll Size:		86118	*404	1.19	1,785.00T
1,500	DV-341	Bermuda Blend Roll Size:		86118	*405	1.19	1,785.00T
1	Shipping	Shipping- BOL				1,900.00	8,925.00 1,900.00
		Address- 12875 N Hwy 77 Newkirk OK 74647					
		DA					
		Sales Tax				0.00%	0.00

Customer Disclosure

No refunds or exchanges unless authorized by TurfHub. Purchasing customer will be responsible for window treatments on any windows that may cause melting of turf material. Damage caused by reflection (melting) or other flammable materials is not covered under turf warranty. Additionally melting caused by other hot surfaces and roll crush is not covered under warranty. Zeolite infill breaking down and discoloring turf is not covered under warranty. Any stains or discoloration caused by excessive watering is also not covered under warranty. Damage caused to turf material by invasive vegetation including but not limited to, nut grass nut sage, roots and similar growths will not be covered under warranty. All synthetic turf is subject to normal wear and tear. Normal wear and tear is not a manufacturer defect and is not covered under warranty.

Any invoice that becomes more than 30 days past due, can and will be subject to auto debiting from your checking account or credit card without notice and a 15% restocking fee will be charged for all returns

By signing or receiving this invoice by email you are agreeing to the terms and conditions listed on this invoice.

Signature \_\_\_\_\_ Date \_\_\_\_\_

Subtotal	\$10,825.00
Total	\$10,825.00
Payments/Credits	\$0.00
Balance Due	\$10,825.00



Estimate

Date	Estimate #
3/19/2024	19208

Bill To
Heartland Sports Turf Jason McMahan 101 Stewart Rd Stigler, OK 74462

Ship To
4402 SW 44th St Oklahoma City, OK 73119

P.O. No.	Terms	Ship Date	Sales Rep
7 Clans Phase 2	Net 30	4/18/2024	DA

Quantity	Item	Description	Price Each	Roll ID #	Total
1,500	DV-320	Bermuda Blend Roll Size:	1.29		1,935.00T
1,500	DV-321	Bermuda Blend Roll Size:	1.29		1,935.00T
1,500	DV-322	Bermuda Blend Roll Size:	1.29		1,935.00T
1,500	DV-323	Bermuda Blend Roll Size:	1.29		1,935.00T
1,500	DV-324	Bermuda Blend Roll Size:	1.29		1,935.00T
1,500	DV-325	Bermuda Blend Roll Size:	1.29		1,935.00T
1,500	DV-326	Bermuda Blend Roll Size:	1.29		1,935.00T
1,500	DV-327	Bermuda Blend Roll Size:	1.29		1,935.00T
1,500	DV-328	Bermuda Blend Roll Size:	1.29		1,935.00T
1,500	DV-329	Bermuda Blend Roll Size:	1.29		1,935.00T
1,500	DV-330	Bermuda Blend Roll Size:	1.29		1,935.00T
1,500	DV-331	Bermuda Blend Roll Size:	1.29		1,935.00T
1,500	DV-332	Bermuda Blend Roll Size:	1.29		1,935.00T
1,500	DV-333	Bermuda Blend Roll Size:	1.29		1,935.00T
1,500	DV-334	Bermuda Blend Roll Size:	1.29		1,935.00T
					29,025.00
			Subtotal		
			Total		

## Estimate

Date	Estimate #
3/19/2024	19208

Bill To
Heartland Sports Turf Jason McMahan 101 Stewart Rd Stigler, OK 74462

Ship To
4402 SW 44th St Oklahoma City, OK 73119

P.O. No.	Terms	Ship Date	Sales Rep
7 Clans Phase 2	Net 30	4/18/2024	DA

[illegible]



Heartland Sports Turf, Inc.

Quotation

101 Stewart Road | Stigler, OK 74462 | 405.915.5155 | 405.642.9592

Date: March 13, 2024  
Project: Newkirk 7 Clans Casino - PH 2 RV Park Turf Islands

BILL TO: Scott + Reid General Contractors SHIP TO: Newkirk Casino

We are pleased to quote the following items: Attn: Mr. Brian Travis

TERMS: Net 30 \*Pricing valid for 45 days

ITEM NO.	QTY	DESCRIPTION	UNIT	UNIT PRICE	TOTAL
	9	PH 2 RV Park Islands - 1200sf Each Includes All Required Turf, Aggregate & Materials Sub Base to be 6" from Grade		\$ 8,895.00	\$ 80,055.00
	11	RV Island Table Assembly & Installation Anchored to Concrete		\$ 375.00	\$ 4,125.00
	11	RV Island Grill Assembly & Installation Set into Concrete		\$ 375.00	\$ 4,125.00
	1	Additional 4,500sf of synthetic turf around existing building. Includes all required turf, aggregate & materials. Sub base to be 6" from final grade.  Pricing Includes Materials, Freight & Labor to Install Tables and Grills Provided by Owner  NOTES: SALES TAX IS NOT INCLUDED GRILLS & TABLES PROVIDED BY OWNER		\$ 33,390.00	\$ 33,390.00
Thank You !					

Authorized by

Please return with order

Jen McMahon  
HST

Subtotal  
  
Total \$ 121,695.00

www.heartlandsturf.com  
D: (405) 915-5155



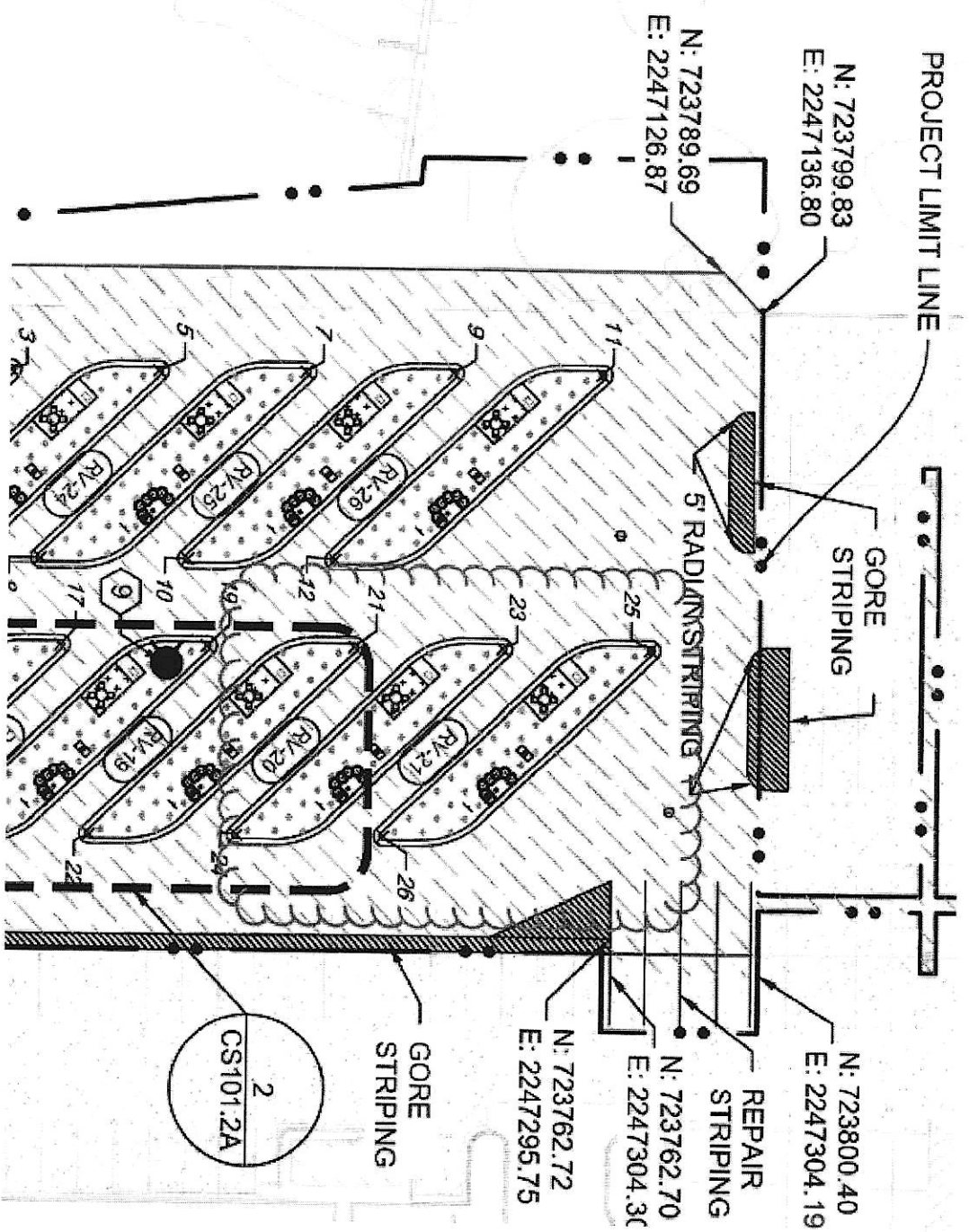

Make 7th - David McLain

No. \_\_\_\_\_

# Heartland Sports Turf

## Submittal

Date: January 5, 2024

Project Name: Otoe Missouri RV Park

Submittal: Turf

Spec#: 329200 - Turf and Grasses





# TurfHub

SYNTHETIC GRASS SUPPLIER

## BERMUDA BLEND

SKU: BERMUDA-BLEND

Bermuda Blend features a mix of olive green and field green turf fibers that delivers a superior natural aesthetic. The turfs Mini Wave shaped yarn fibers are highly durable and disperse sunlight, giving the turf a low sheen and a surface that is 15 degrees cooler to the touch. This synthetic grass is perfect for any home yardscape.

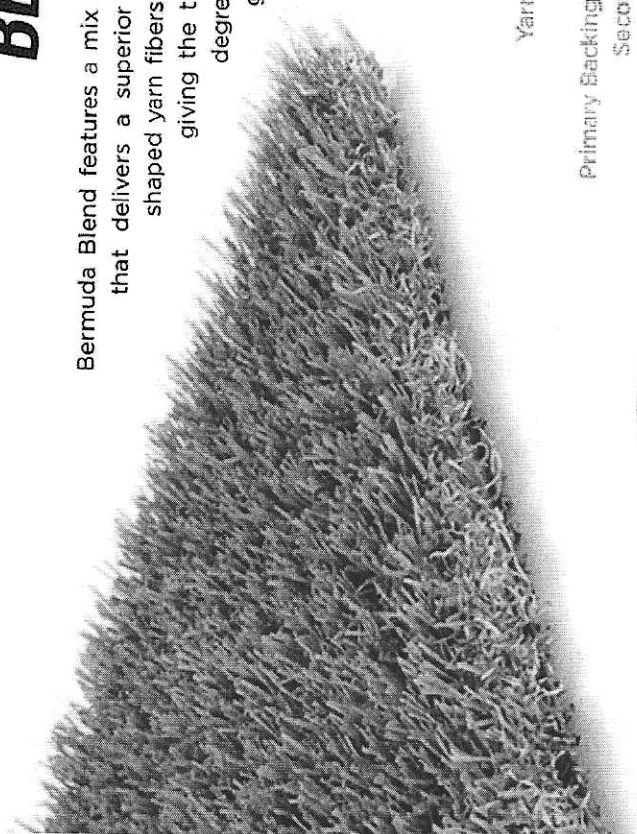

Pile Height: **1 1/2"**  
Face Weight: **55 oz**  
Total Weight: **82 oz**  
Yarn Color: **Field/Olive**  
Thatch Color: **Brown/Green**  
Yarn Material: **Monofilament Polyethylene (PE)**  
Thatch Material: **Texturize PE**  
Primary Backing Material: **7oz Dual Layered Non-expansive**  
Secondary Coating Material: **20oz Polyurethane**  
Tuft Bind: **>10 lbs.**  
Machine Gauge: **3/8"**  
Infill Ratio: **1-2 lbs**  
Roll Width: **15' feet**  
Drain Rate: **>28 inch per hour**  
Warranty: **15 year**  
Recommended Use: **Low to Moderate Traffic**



### FEATURES

- CoolFlo Technology—Yarn shape increases airflow and lowers surface temperature
- Unique Mini Wave blade design deflects light reduces sheen
- Durable yarn shape creates stronger fiber strength
- UV stabilized yarns to resist fading from the sun
- Non-flammable, anti-acid yarn resistant to chemical attack

View this product in detail online at [www.turfhub.com/product/bermuda-blend/](http://www.turfhub.com/product/bermuda-blend/)







DATE: 07-07-2022

TEST NUMBER: 0405085

**CLIENT**

## Go Green - Turf Evolutions

TEST CONDUCTED

Surface Flammability of Carpets and Rugs (16 CFR Chapter II, Subchapter D, Part 1630 CPSC FF-170) also referenced as ASTM D2859



PRODUCT NAME

HMAXX 65

## DESCRIPTION OF PRODUCT TESTED

Turf

## REFERENCE

PO #15718

### TEST CRITERION

The uncharred area of the test specimen must be greater than one inch in at least seven of the eight specimens tested in order to meet the acceptance criterion.

## TEST RESULTS

	SPECIMEN NUMBER							
	1	2	3	4	5	6	7	8
Uncharred Area (Inches)	3.5	1.7	3.3	3.0	3.4	3.3	2.6	3.0

**NOTE: This Sample was tested on the face side.**

**This sample PASSES the Federal Flammability Standard DOC FF 1-70**

**APPROVED BY:**

Harry A. Curry

This report is provided for the exclusive use of the client to whom it is addressed. It may be used in its entirety to gain product acceptance from duly constituted authorities. This report applies only to those samples tested and is not necessarily indicative of apparently identical of similar products. This report, or the name of Professional Testing Laboratory Inc. shall not be used under any circumstance in advertising to the general public.

714 Glenwood Place

Dalton GA 30721

Phone: 706-226-3283

Fax: 706-225-6787

email: [protest@outlink.us](mailto:protest@outlink.us)



TurfHub  
SYNTHETIC GRASS SUPPLIER

1725 E. GERMANN RD. SUITE 19 | CHANDLER, AZ 85286  
1.800.383.8229 | TURFHUB.COM

Invoice

Date	Invoice #
10/5/2023	77433

Bill To	Ship To
Heartland Sports Turf Jason McMahan 101 Stewart Rd Stigler, OK 74462	Outbound Jason Si'i 12875 N Hwy 77 Newkirk OK 74647

		Rep	P.O. Number	Terms	Ship Date	Project	
		DA	DLM 7 Clans	Net 30	10/5/2023		
Quantity	Item	Description		MO #	Roll #	Price Each	Amount
1,500	AP-160 (1)	Bermuda Blend Roll Size:  15x100 **DLM**		75813	107	2.50	3,750.00T
1,500	AP-161 (1)	Bermuda Blend Roll Size:  15x100 **DLM**		75813	106	2.50	3,750.00T
1	Shipping	Shipping- Jason Si'i BOL  Address- 12875 N Hwy 77 Newkirk OK 74647  DA Sales Tax				1,200.00	7,500.00 1,200.00
						0.00%	0.00

Customer Disclosure

No refunds or exchanges unless authorized by TurfHub. Purchasing customer will be responsible for window treatments on any windows that may cause melting of turf material. Damage caused by reflection (melting) or other flammable materials is not covered under turf warranty. Additionally melting caused by other hot surfaces and roll crush is not covered under warranty. Zeolite infill breaking down and discoloring turf is not covered under warranty. Any stains or discoloration caused by excessive watering is also not covered under warranty. Damage caused to turf material by invasive vegetation including but not limited to, nut grass nut sage, roots and similar growths will not be covered under warranty. All synthetic turf is subject to normal wear and tear. Normal wear and tear is not a manufacturer defect and is not covered under warranty.

Any invoice that becomes more than 30 days past due, can and will be subject to auto debiting from your checking account or credit card without notice and a 15% restocking fee will be charged for all returns

By signing or receiving this invoice by email you are agreeing to the terms and conditions listed on this invoice.

Signature \_\_\_\_\_ Date \_\_\_\_\_

Subtotal	\$8,700.00
Total	\$8,700.00
Payments/Credits	\$0.00
Balance Due	\$8,700.00





INVOICE #1

101 Stewart Road | Stigler, OK 74462 | 405.915.5155 | 405.642.9592

Date: November 27, 2023  
Project: Newkirk 7 Clans Casino - PH 2 RV Park Turf Islands

BILL TO : Scott + Reid General Contractors      SHIP TO: Newkirk Casino

We are pleased to quote the following items:      Attn: Mr. Brian Travis

TERMS: Net 30      \*Pricing valid for 45 days

QTY BALACE	QTY	DESCRIPTION	UNIT	UNIT PRICE	TOTAL THIS INVOICE
7.29	11	PH 2 RV Park Islands - 1200sf Each Includes All Required Turf, Aggregate & Materials Sub Base to be 6" from Grade	3.71	\$ 8,895.00	\$ 33,000.45
11	11	RV Island Table Assembly & Installation Anchored to Concrete	0	\$ 00.00	\$ 00.00
11	11	RV Island Grill Assembly & Installation Set into Concrete	0	\$ 00.00	\$ 00.00
1	1	Travel is Included  Pricing Includes Materials, Freight & Labor to Install Tables and Grills Provided by Owner  NOTES: SALES TAX IS NOT INCLUDED GRILLS & TABLES PROVIDED BY OWNER See Notes Below, Thank You !	0		

Authorized by _____	Please return with order	Subtotal	
		Total	\$ 33,000.45

Jason McMahan



www.heartlandsportsturf.com  
D: (405) 915-5155





**INVOICE #1**

Notes:

1. See TurfHub Estimate Attached for All Turf Required - for Direct Pay
2. \$33,000.45 Down Payment for Mobilization and Installation Materials
3. TurfHub should be the ONLY Direct Pay

Jason McMahan



[www.heartlandsportsturf.com](http://www.heartlandsportsturf.com)

D: (405) 915-5155



**TurfHub**  
SYNTHETIC GRASS SUPPLIER

1725 E. GERMANN RD. SUITE 19 | CHANDLER, AZ 85286  
1.800.383.8229 | TURFHUB.COM

Estimate

Date	Estimate #
11/2/2023	17705

Bill To	Ship To
Heartland Sports Turf Jason McMahan 101 Stewart Rd Stigler, OK 74462	Jason Si'i 12875 N Hwy 77 Newkirk OK 74647

					Ship Date	P.O. No.	Sales Rep	
					12/2/2023		DA	
Quantity	Item	Description	MO #	Roll #	Roll Notes	Notes	Price Each	Total
15,000	Bermuda ...	Bermuda Blend Roll Size:					1.29	19,350.00T
	Shipping	Shipping- BOL Q#  Address- 12875 N Hwy 77 Newkirk OK 74647  DA Sales Tax					2,500.00	19,350.00 2,500.00
							0.00%	0.00
					Subtotal		\$21,850.00	
					Total		\$21,850.00	



OM3 Construction LLC  
Turfhub LLC

03/06/2024

Check No. 31392

Document No.	Doc. Date	Reference No.	Description	Amount
17705	3/5/2024	Cost Code - 10280-1	OM3-2023-75-ODPI-01	21,850.00

Total 21,850.00

OM3 Construction LLC  
Turfhub LLC

03/06/2024

Check No. 31392

Vendor No.: TURFHUB LLC

Document No.	Doc. Date	Reference No.	Description	Amount
17705	3/5/2024	Cost Code - 10280-1	OM3-2023-75-ODPI-01	21,850.00

Total 21,850.00

OM3 Construction LLC  
4111 Perimeter Center Place  
Oklahoma City, OK 73112

Equity Bank  
P.O. Box 468  
Newkirk, OK 74847

31392

DATE  
03/06/2024

AMOUNT  
\$\*\*\*\*\*21,850.00

PAY \*\*\*\*TWENTY ONE THOUSAND EIGHT HUNDRED FIFTY AND 0/100

TO THE Turfhub LLC  
ORDER 1725 E Germann Rd, Unit 19  
OF Chandler, AZ 85286

*Leah Hargan*  
*ghk*

⑈ 3 1 3 9 2 ⑈ ⑆ 1 0 1 1 0 5 3 5 4 ⑆ ⑈ 7 4 0 1 0 0 1 6 8 7 ⑈

ENDORSE HERE

DO NOT WRITE, STAMP OR SIGN BELOW THIS LINE  
RESERVED FOR FINANCIAL INSTITUTION USE \*





# Quotation

101 Stewart Road | Stigler, OK 74462 | 405.915.5155 | 405.642.9592

Date: September 29, 2023  
Project: Newkirk 7 Clans Casino - PH 2 RV Park Turf Islands

BILL TO : Scott + Reid General Contractors      SHIP TO: Newkirk Casino

We are pleased to quote the following items:      Attn: Mr. Brian Travis

TERMS: Net 30      \*Pricing valid for 45 days

ITEM NO.	QTY	DESCRIPTION	UNIT	UNIT PRICE	TOTAL
	11	PH 2 RV Park Islands - 1200sf Each Includes All Required Turf, Aggregate & Materials Sub Base to be 6" from Grade		\$ 8,895.00	\$ 97,845.00
	11	RV Island Table Assembly & Installation Anchored to Concrete		\$ 375.00	\$ 4,125.00
	11	RV Island Grill Assembly & Installation Set into Concrete		\$ 375.00	\$ 4,125.00
	1	Travel is Included			
		Pricing Includes Materials, Freight & Labor to Install Tables and Grills Provided by Owner			
		NOTES: SALES TAX IS NOT INCLUDED GRILLS & TABLES PROVIDED BY OWNER Thank You !			
				Subtotal	
				Total	\$ 106,095.00

Authorized by \_\_\_\_\_

Please return with order

Jason McMahan



www.heartlandsturf.com  
D: (405) 915-5155



Kenneth Crawford <kenneth@heartlandsportsturf.com>

Reminder: Payment Request from TURFHUB, LLC

1 message

TURFHUB, LLC <quickbooks@notification.intuit.com>

To: heartlandsportsturf@gmail.com

Cc: kenneth@heartlandsportsturf.com, dmcclain@scotlandreid.com

TURFHUB, LLC

\$48,023.00

7 Clans Job

Pay

© 2020 Intuit Inc. All rights reserved.

Privacy Security Terms of Service

Oct 13, 2023

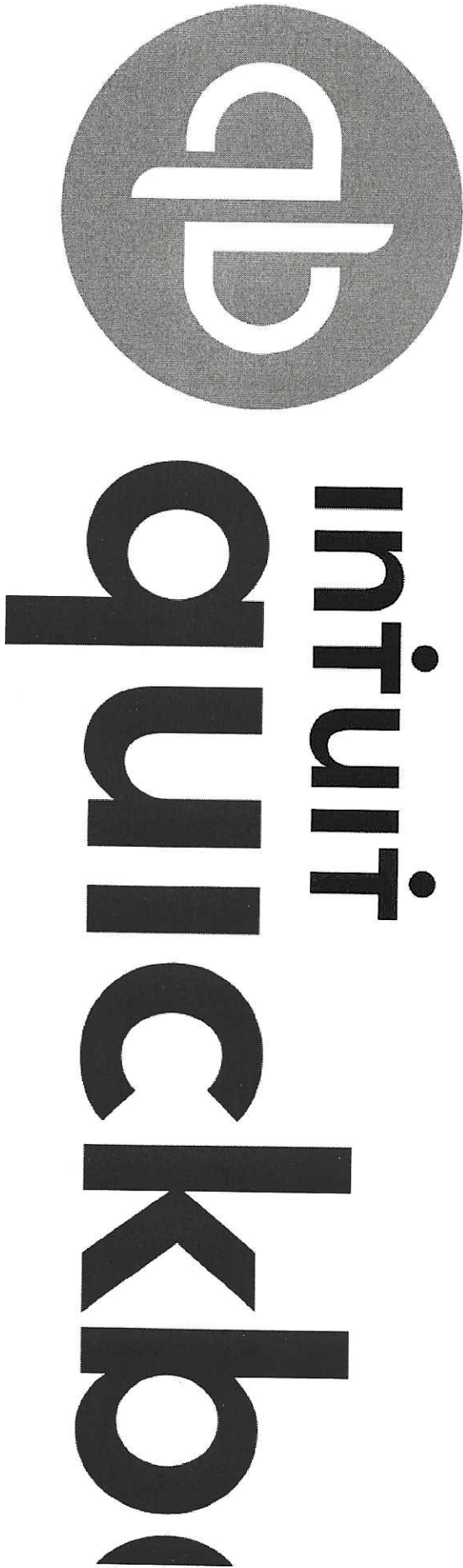

Quickbooks logo



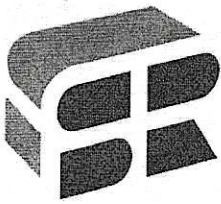

**SCOTT + REID**

General Contractors

**SUBCONTRACT AGREEMENT**

**TEXAS - INTERIORS**

ANY DISPUTE ARISING OUT OF THIS SUBCONTRACT IS SUBJECT TO ARBITRATION. THE ARBITRATION PROCEDURES ARE SET FORTH IN ARTICLE 14 OF THE GENERAL PROVISIONS TO THIS CONTRACT.

This Agreement made this 1/2/2024, and effective the 1/2/2024, by and between **Scott & Reid General Contractors, Inc.** whose principal address is **15207 Addison Rd, Addison, Texas 75001**, hereinafter referred to as the "Contractor" and **Heartland Sports Turf** whose principal address is **101 Stewart Rd, Stigler, OK 74462**, hereinafter referred to as the "Subcontractor," to perform part of the work on the following project:

**PROJECT:**

**3.608 Otoe Missouriia - RV Park PH 2  
12875 North Highway 77  
Newkirk, OK 74647**

**SUBCONTRACT SUM:**

**106,095.00 (ONE HUNDRED SIX THOUSAND NINETY-FIVE AND XX / 100 Dollars)**

**JOB NUMBER:**

**3608-1-03**

(Please include this reference number on all invoices and job inquiries.)

**NOW, THEREFORE**, in consideration of the mutual covenants herein made by Contractor and Subcontractor, the parties mutually agree as follows:

1. Subcontractor promises, covenants and agrees to furnish all labor, material, management, equipment, tools, plant, scaffolding, SPECIALTIES \$106,095.00

The above described Work is for the construction of the above-named Project and will be performed in accordance with the Contract Documents as defined in the "General Provisions" of Contractor's Subcontract Agreement.

2. Contractor agrees to pay Subcontractor for the described Work, and Subcontractor agrees to accept therefore, the Subcontract Sum as stated above, such payment to be made in accordance with the General Provisions of the Subcontract Agreement.

3. Subcontractor shall perform its Work in a timely manner in accordance with Article 7 of the 2020 General Provisions of Subcontract Agreement.

4. Subcontractor represents that it is qualified to perform the Work and that it is knowledgeable of the materials, methods, equipment and apparatus specified for the Work, and that it has or will have sufficient work forces to timely complete the Work. Subcontractor acknowledges that it has (a) ascertained and fully evaluated the Work required by the Contract Documents, and the conditions and difficulties involved in performing the same; (b) satisfied itself as to the correctness and accuracy of information furnished by Contractor, Architect, Owner or others; and (c) reviewed and accepted the information regarding the Owner's ability to pay for the Work and is satisfied as to the financial integrity of Owner and its ability to pay for the Work. Subcontractor agrees that any failure by Subcontractor to become fully informed of the conditions and difficulties involved in performing the Work will not relieve Subcontractor from its responsibilities under the Contract Documents.

5. The General Provisions and any exhibits or additions attached or referenced therein are incorporated into and made a part

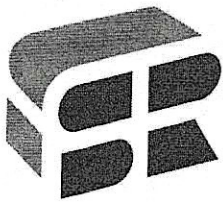

SCOTT + REID

General Contractors

15207 Addison Rd  
Addison, TX 75001  
Ph : (469) 374-3400

Letter of Transmittal

To: Heartland Sports Turf  
101 Stewart Rd  
Stigler, OK 74462  
Attn: Heartland Sports Turf

Transmittal #: 4  
Date: 1/2/2024  
Job: 3.608 Otoe Missouriia - RV Park PH 2

Subject: Subcontract

- WE ARE SENDING YOU
- ☐ Shop drawings

☐ Copy of letter
- ☐ Attached

☐ Prints

☐ Change order
- ☐ Under separate cover via the following items:

☐ Plans

☐ Specifications

☐ Samples

☒ Subcontract

Document Type	Copies	Date	No.	Description
Commitment	1	1/2/24	3608-1-03	Turf

THESE ARE TRANSMITTED as checked below:

- ☐ For approval

☐ For your use

☐ As requested

☐ For review and comment

☐ FOR BIDS DUE
- ☐ Approved as submitted

☐ Approved as noted

☐ Returned for corrections

☐ Other

☐ PRINTS RETURNED AFTER LOAN TO US
- ☐ Resubmit \_\_\_ copies for approval

☐ Submit \_\_\_ copies for distribution

☐ Return \_\_\_ corrected prints

Remarks:

From:

Signature: \_\_\_\_\_

If enclosures are not as noted, kindly notify us at once.



of this Subcontract Agreement. Other Contract documents include but are not limited to the Scope of Work, Plans and Specifications, Project Schedule, PCO Form, Lien Waiver Forms, and Insurance Requirements of the Owner, if any.

6. Subcontractor shall be solely responsible for ensuring that an authorized representative of Subcontractor signs the Subcontract and other documents whether by handwritten, electronic, or digital signature and agrees not to contest the validity or enforceability of any signature on any document that is so conveyed. Subcontractor agrees that Subcontractor's signature on this Subcontract Agreement indicates its agreement to the terms of the unmodified Subcontract Agreement and 2020 General Provisions. No signature of Contractor is required to fully effectuate Contractor's agreement to these terms. Should Subcontractor desire a Contractor executed version of this Agreement, Subcontractor may return two executed copies of the Agreement to Contractor and Contractor will endeavor to return a fully executed copy to Subcontractor. In no event shall this Agreement be deemed invalid or unenforceable due to Contractor's lack of signature. If requested, Subcontractor agrees to sign the Subcontract and other Contract Documents utilizing Contractor's electronic signature process which, at the Contractor's discretion, may be facilitated through a third-party administrator.

Heartland Sports Turf

By:  \_\_\_\_\_  
Subcontractor Signature

Printed name \_\_\_\_\_  
Title: VP \_\_\_\_\_  
Phone No.: 406.216.7726 \_\_\_\_\_  
Email Address: \_\_\_\_\_

Scott & Reid General Contractors, Inc.

By: \_\_\_\_\_  
Contractor Signature

Bradley D. Reid  
President  
Phone No.: 469.374.3400  
Email Address: [email@scottandreid.com](mailto:email@scottandreid.com)

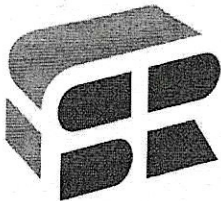

Standard Invoice Form

To: Scott + Reid General Contractors  
15207 Addison Rd  
Addison, TX 75001  
469.374.3400  
[ap@scottandreid.com](mailto:ap@scottandreid.com) (Dallas)  
[apayable@scottandreid.com](mailto:apayable@scottandreid.com) (Houston)

From: Heartland Sports Turf  
101 Stewart Rd  
Stigler, OK 74462

Project Name	S+R Job Number	Sub Invoice Number	Bill Through	Draw Number
Otoe Missouria - RV Park PH	3.608			

Original Contract Amount:106,095.00

Approved Change Orders (CO) to Date:

Revised Contract Amount:

Total Work Completed to Date:

Less **Gross** Amount Previously Invoiced:

**Gross** Amount Due This Pay Period:

Less 10% Retainage:

Net Due This Payment:

Subcontractor CO Number	S+R Subcontract CO Number**	Description of Change	Amount

*\*\*If a subcontract change order has not been issued by S+R, please note the S+R employee/date this change was "approved."*

**Incomplete applications will be rejected. Once rejected, you will not be eligible to submit a pay application until the following month.**



SCOTT + REID  
General Contractors

UPDATED  
6-Apr-24

Standard Invoice Form

To: Scott + Reid General Contractors  
15207 Addison Rd  
Addison, TX 75001  
469.374.3400  
ap@scottandreid.com (Dallas)  
apayable@scottandreid.com (Houston)

From: Heartland Sports Turf  
101 Stewart Rd  
Stigler, OK 74462

Project Name	S+R JobNumber	Sub InvoiceNumber	BillThrough	DrawNumber
Otoe Missouri - RV Park PH 2	3.608-1-03	Pay #	15-Apr-24	
Original Contract Amount:		\$106,095.00		
Approved Change Orders (CO) to Date:		\$71,521.86		
Revised Contract Amount:		\$177,616.86		
Total Work Completed to Date:		100%		
Less Gross Amount Previously Invoiced:		\$21,850.00	S&R CH#17705 Turf Hub	TH-#17705 (\$1.29) 10 Rolls
Gross Amount Due This Pay Period:		\$155,766.86		
Less 10% Retainage:		\$15,576.69		
Net Due This Payment:		\$140,190.17		
SubcontractorCo Number	HSTSubcontractCO Number*	Description of Change	Amount	
Change Order #1	HST	Contract Labor - See Quote Attached	\$0.00	
Change Order #2R1	HST	Labor ADD for Installation ONLY of Grills & Tables	\$0.00	
			\$0.00	
			\$0.00	
Turf Hub	#77433 (10-05-2023)	WHAT WAS THIS FOR - PH 1 EXTRA ROLL	\$8,700.00	
Turf Hub	#84935 - (4-1-2024)	15 Rolls Turf (86118) Bermuda Blend (\$1.19) + Shipping	\$29,775.00	
Turf Hub	#85125 - (4-4-2024)	5 Rolls Turf (86118) Bermuda Blend (\$1.19) + Shipping	\$10,825.00	
			\$140,190.17	
			\$49,300.00	
			\$90,890.17	

\* If a subcontract change order has not been issued by S+R, please not the S+R employee/detect this

\*\* If a subcontract change order has not been issued by S+R, please not the S+R employee/date this change was "approved."

Incomplete applications will be rejected. Once rejected, you will no be eligible to submit a pay application until the following month.

SUBCONTRACT AGREEMENT  
SCOTT + REID GENERAL CONTRACTORS, INC.





Quotation

101 Stewart Road | Stigler, OK 74462 | 405.915.5155 | 405.642.9592

Date: September 29, 2023  
Project: Newkirk 7 Clans Casino - PH 2 RV Park Turf Islands

BILL TO : Scott + Reid General Contractors      SHIP TO: Newkirk Casino

We are pleased to quote the following items:      Attn: Mr. Brian Travis

TERMS: Net 30

\*Pricing valid for 45 days

ITEM NO.	QTY	DESCRIPTION	UNIT	UNIT PRICE	TOTAL
	11	PH 2 RV Park Islands - 1200sf Each Includes All Required Turf, Aggregate & Materials Sub Base to be 6" from Grade		\$ 8,895.00	\$ 97,845.00
	11	RV Island Table Assembly & Installation Anchored to Concrete		\$ 375.00	\$ 4,125.00
	11	RV Island Grill Assembly & Installation Set into Concrete		\$ 375.00	\$ 4,125.00
	1	Travel is Included			
		Pricing Includes Materials, Freight & Labor to Install Tables and Grills Provided by Owner			
		NOTES: SALES TAX IS NOT INCLUDED GRILLS & TABLES PROVIDED BY OWNER Thank You !			
				Subtotal	
				Total	\$ 106,095.00

Authorized by \_\_\_\_\_

Please return with order

Jason McMahan



www.heartlandsportsturf.com  
D: (405) 915-5155